

# Copy and Transcription of William Hiorns' Plan of 1762

Showing the Owners/Occupiers of pews in  
Holy Trinity Parish Church,  
Sutton Coldfield



On Heritage Open Day 2019, there was a display in Holy Trinity Parish Church relating to the so-called “Box Pew Rumpus” which took place there in the 1760s. A review of that display can be seen in the *Galleries* section of our website ([www.sclhrg.org.uk](http://www.sclhrg.org.uk)) entitled “Holy Trinity Parish Church Heritage Open Day 2019”.

If you owned a house in Sutton Coldfield in the 18<sup>th</sup> century, it entitled you to a specific pew in the church. If you sold your house, you gave up that pew. However, a major upset occurred in 1762 when new pews were installed in the Church by the Corporation. It was their right to decide on the arrangement of the seating. However, unauthorised people began to claim some of the seats and old parishioners, who had occupied pews for many years, complained about the position of their new ones. This led to many disgruntled people in the congregation taking steps to redress the situation – hence the “Box Pew Rumpus”.

A plan by William Hiorns was drawn up in 1762 to show the new allocation and, as promised in the review of the display, a copy of that plan is now included herewith, together with a Transcription of it showing a list of the owners/occupiers of the pews. As many of the residents of the town are named, this list can be a very useful record for people researching the history of Sutton Coldfield.

Further information can be obtained about the “Box Pew Rumpus” in N.G. Evans’ book, *Investigation of Holy Trinity Church 1988* (Sutton Library Ref: BCOLQ726.50942496HOL).

Janet Jordan  
Sutton Coldfield Local History Research Group  
January 2024

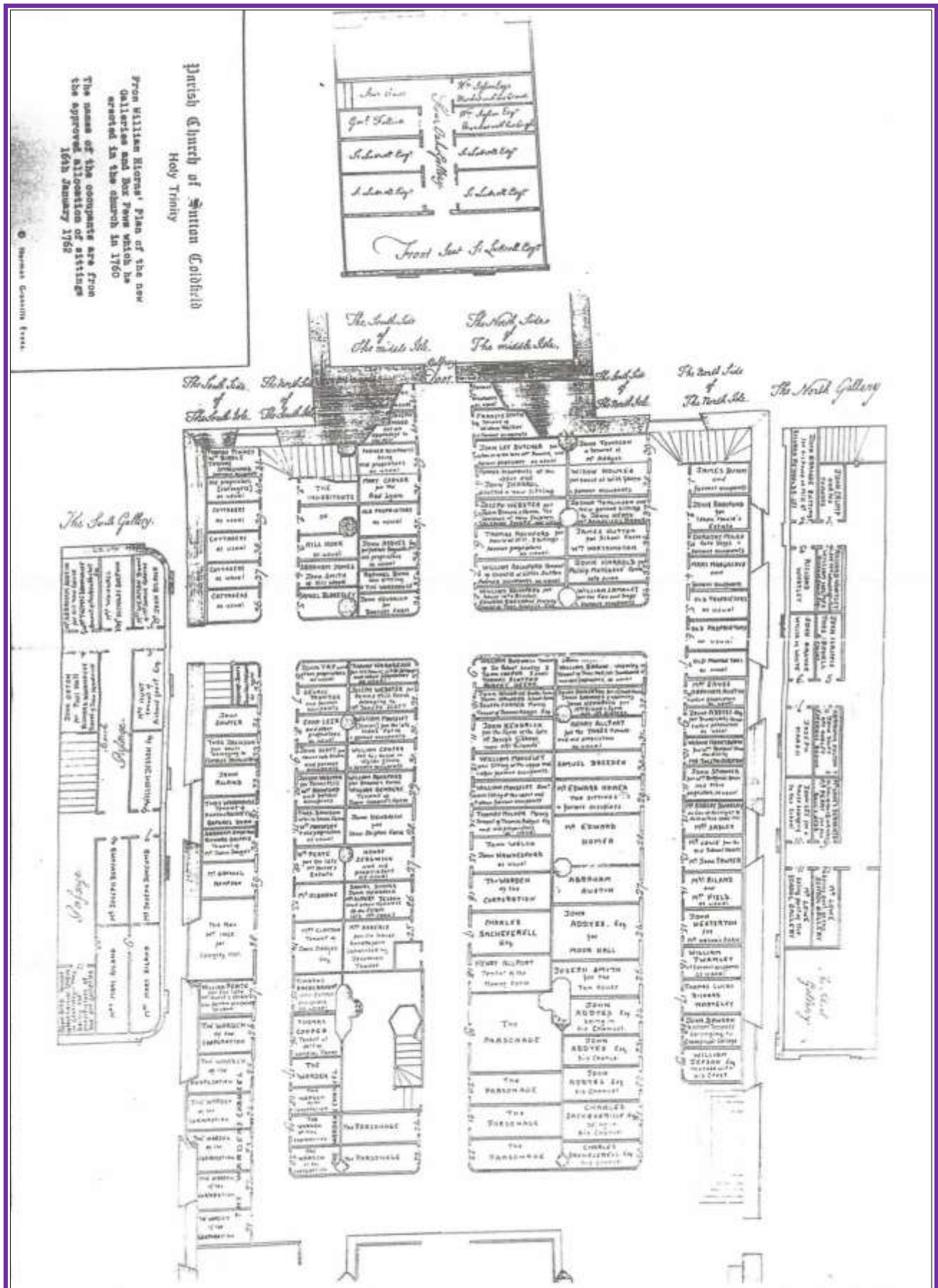

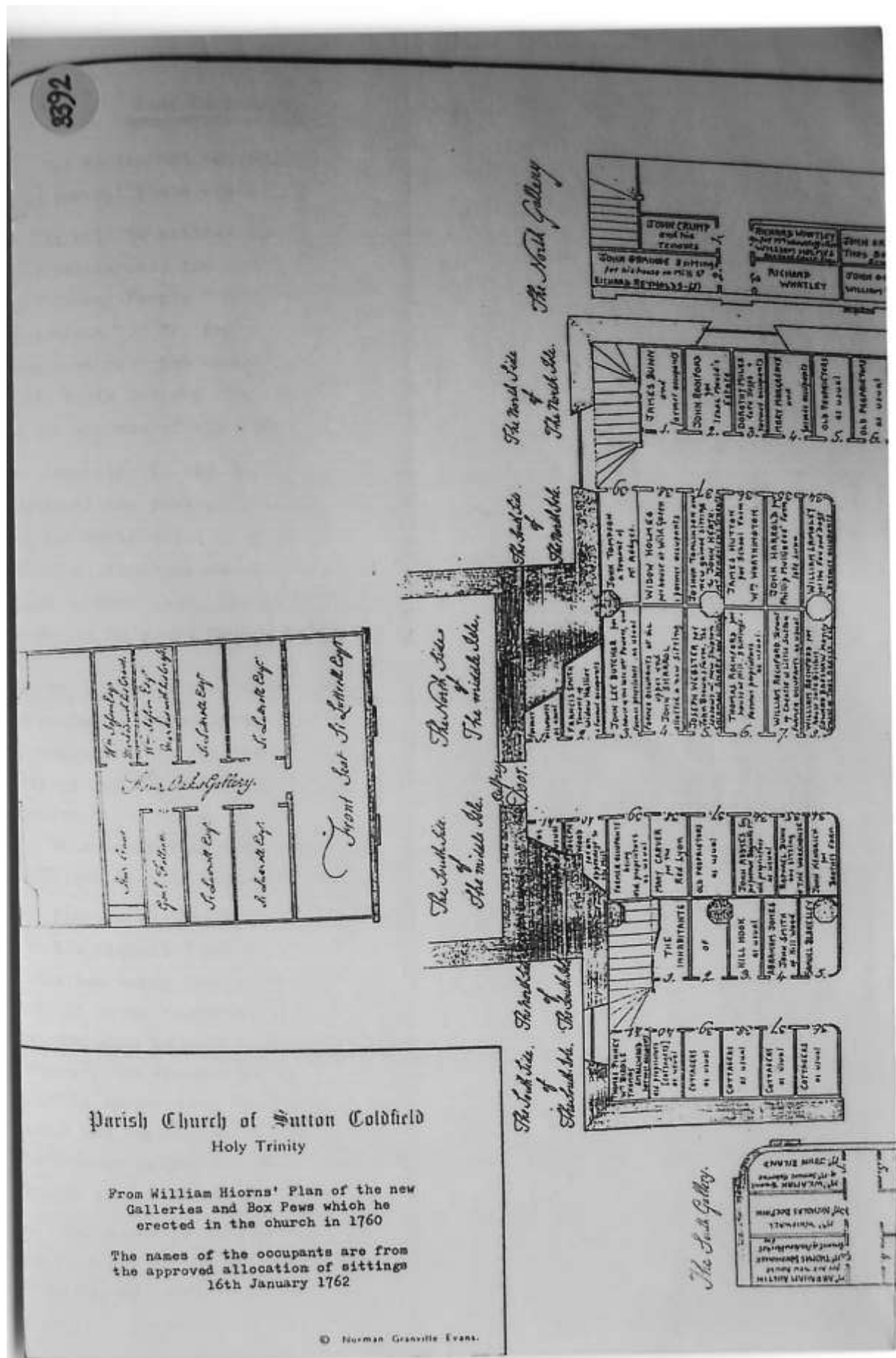



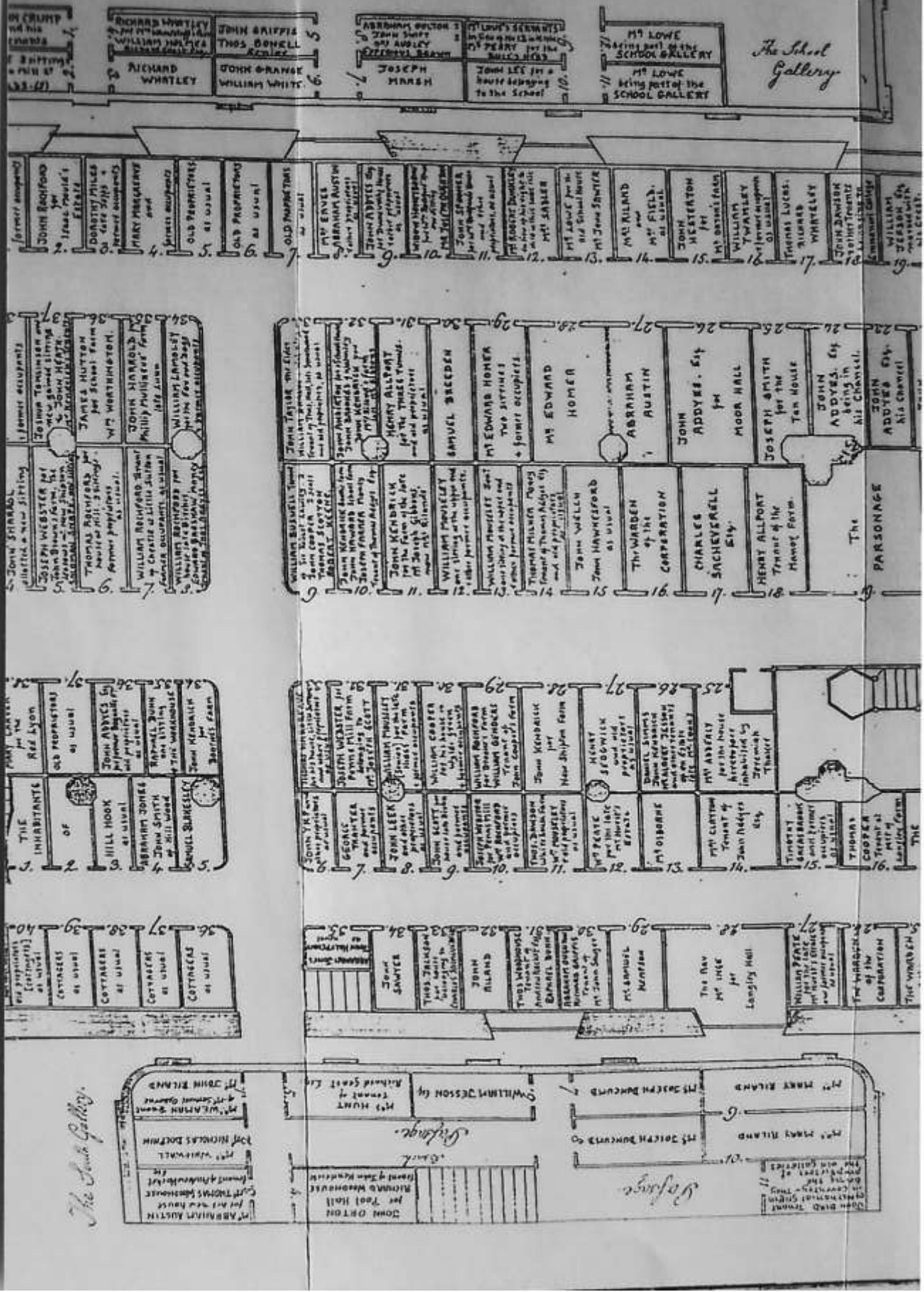

3392

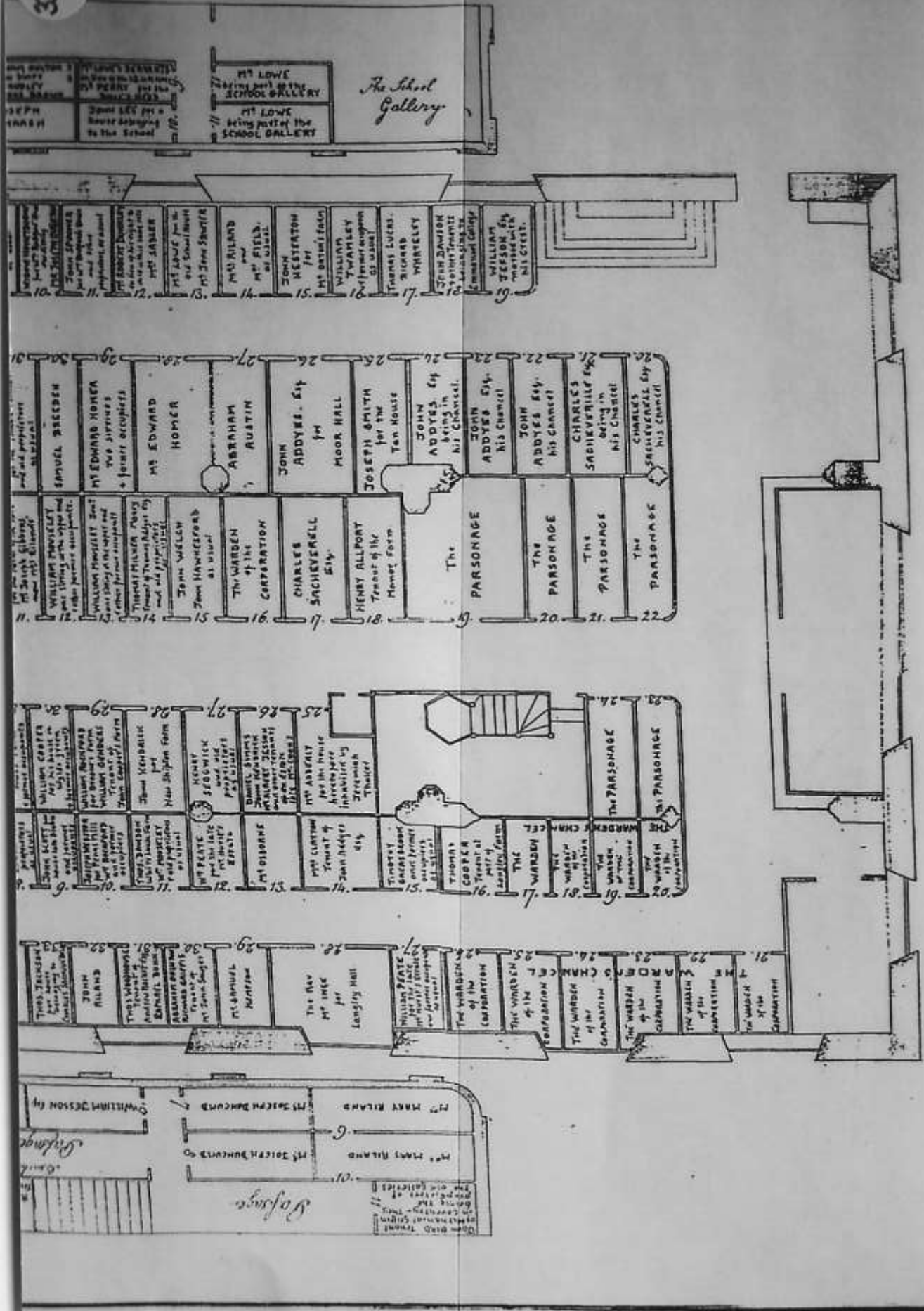



## *Parish Church of Sutton Coldfield*

Holy Trinity

**From William Hiorns' Plan of the new  
Galleries and Box Pews which he  
erected in the church in 1760**

**The names of the occupants are from  
the approved allocations of sittings  
16th January 1762**

© Norman Granville Evans.

### *Four Oaks Gallery*

South Side  
South Side  
South Side  
North Side  
North Side  
North Side  
North Side  
Front Seat

General Folliott  
Si (*Simon*) Luttrell Esq  
Si Luttrell Esq  
Wm Jesson Esq, Marked with his Crest  
Wm Jesson Esq, Marked with his Crest  
Si Luttrell, Esq  
Si Luttrell, Esq  
Si Luttrell, Esq

### *The South Gallery*

1. The South Gallery
1. The South Gallery
2. The South Gallery
2. The South Gallery
3. The South Gallery
3. The South Gallery
4. The South Gallery
4. The South Gallery
5. The South Gallery
6. The South Gallery
7. The South Gallery
8. The South Gallery
9. The South Gallery
10. The South Gallery
11. The South Gallery

WEAMAN, Mrs, Tenant of Mr. Samuel Osborne  
RILAND, Mr John  
WHIGWALL, Mrs  
DOLPHIN, Mr Nicholas  
AUSTIN, Mr. Abraham, for his new house.  
WOODHOUSE, Mr Thomas, tenant of Andrew Hacket Esq  
ORTON, John, for Pool Hall  
WOODHOUSE, Richard, Tenant of John Kendrick  
HUNT, Mrs, Tenant of Richard Geast, Esq  
JESSON, William, Esq  
DUNCUMB, Mr. Joseph  
DUNCUMB, Mr Joseph  
RILAND, Mrs Mary  
RILAND, Mrs Mary  
BIRD, John, Tenant of Nathaniel Griffin in Coventry - They  
being the proprietors of the old Galleries.

## *The South Isle*

1.	The North Side of The South Isle	THE INHABITANTS of HILL HOOK as usual
2.	The North Side of the South Isle	THE INHABITANTS of HILL HOOK as usual
3.	The North Side of the South Isle	THE INHABITANTS of HILL HOOK as usual
4.	The North Side of the South Isle	JONES, Abraham
4.	The North Side of the South Isle	SMITH, John, of Hill Wood
5.	The North Side of the South Isle	BLAKESLEY, Samuel
6.	The North Side of the South Isle	YRP ( <i>Earp?</i> ), John, and other proprietors as usual
7.	The North Side of the South Isle	TRANTER, George, and former occupants
8.	The North Side of the South Isle	LEEK, John, and other proprietors as usual
9.	The North Side of the South Isle	SCOTT, John, for house late Dixon, and former occupants
10.	The North Side of the South Isle	WEBSTER, Joseph, for Penns Mill
10.	The North Side of the South Isle	ROCHFORD, Wm, and former occupiers
11.	The North Side of the South Isle	DAWSON, Thos, Whitehouse Farm
11.	The North Side of the South Isle	MOUSELEY, Wm, + old proprietors as usual
12.	The North Side of the South Isle	PEATE, Wm, for the late Mr Hurst's Estate
13.	The North Side of the South Isle	OSBOURNE, Mr
14.	The North Side of the South Isle	CLAYTON, Mrs, Tenant of John Addyes, Esq
15.	The North Side of the South Isle	GREASBROOK, Timothy, and former occupiers as usual
16.	The North Side of the South Isle	COOPER, Thomas, Tenant of part of Langley Farm
17.	The North Side of the South Isle	WARDEN, The
	The Warden's Chancel	
18.	The North Side of the South Isle	WARDEN of the Corporation, The
	The Warden's Chancel	
19.	The North Side of the South Isle	WARDEN of the Corporation, The
	The Warden's Chancel	
20.	The North Side of the South Isle	WARDEN of the Corporation, The
	The Warden's Chancel	
21.	The South Side of the South Isle	WARDEN of the Corporation, The
	The Warden's Chancel	
22.	The South Side of the South Isle	WARDEN of the Corporation, The
	The Warden's Chancel	
23.	The South Side of the South Isle	WARDEN of the Corporation, The
	The Warden's Chancel	
24.	The South Side of the South Isle	WARDEN of the Corporation, The
	The Warden's Chancel	
25.	The South Side of the South Isle	WARDEN of the Corporation, The
	The Warden's Chancel	
26.	The South Side of the South Isle	WARDEN of the Corporation, The
	The Warden's Chancel	
27.	The South Side of the South Isle	PEATE, William, for the late Mr Hurst's Estate and former occupants as usual
28.	The South Side of the South Isle	INGE, The Rev Mr, for Langley Hall
29.	The South Side of the South Isle	KEMPSON, Mr Samuel
30.	The South Side of the South Isle	OUGHTON, Abraham
30.	The South Side of the South Isle	GRIFFIS, Richard, Tenant of Mr John Sawyer
31.	The South Side of the South Isle	WOODHOUSE, Thos, Tenant of Andrew Hacket
31.	The South Side of the South Isle	BUNN, Raphael
32.	The South Side of the South Isle	RILAND, John
33.	The South Side of the South Isle	JACKSON, Thos, for house belonging to Charles Sacheverell
34.	The South Side of the South Isle	SAWYER, John

35.	The South Side of the South Isle	JONES, Abraham
35.	The South Side of the South Isle	HALFPENNY, John, as usual
36.	The South Side of the South Isle	COTTAGERS, as usual
37.	The South Side of the South Isle	COTTAGERS, as usual
38.	The South Side of the South Isle	COTTAGERS, as usual
39.	The South Side of the South Isle	COTTAGERS, as usual
40.	The South Side of the South Isle	Old Proprietors [cottagers] as usual
41.	The South Side of the South Isle	PINNEY, Thomas, former occupier
41.	The South Side of the South Isle	BIDDLE, Wm, former occupier
41.	The South Side of the South Isle	SMALLWOOD, Thomas, former occupier

### *The Middle Isle*

1.	The North Side of the Middle Isle	Former occupants, as usual
2.	The North Side of the Middle Isle	SMITH, Francis, Tenant of Widow Hallier and former occupants
3.	The North Side of the Middle Isle	BUTCHER, John Lee, for house of the late Mrs Powers, and former proprietors as usual
4.	The North Side of the Middle Isle	Former occupants at the upper end
4.	The North Side of the Middle Isle	SHARROL, John, allotted a new sitting
5.	The North Side of the Middle Isle	WEBSTER, Joseph, for John Brown's Farm, The Leasows, at New Shipton
5.	The North Side of the Middle Isle	SNAPE, Solomon, one/new(?) sitting
6.	The North Side of the Middle Isle	ROCHFORD, Thomas, for house at Hill, 2 sittings, former proprietors as usual
7.	The North Side of the Middle Isle	ROCHFORD, William, Tenant of Cheatle at Little Sutton, former occupants as usual
8.	The North Side of the Middle Isle	ROCHFORD, William, for house late Birches
8.	The North Side of the Middle Isle	BAGSHAW, Edward, Maney, Tenant of Thos Addyes, Esq
9.	The North Side of the Middle Isle	BOSWELL(?), William, Tenant of Sir Robert Lawley 2
9.	The North Side of the Middle Isle	COOPER, John, 2 seats
9.	The North Side of the Middle Isle	SCOTTON, Thomas
9.	The North Side of the Middle Isle	KEENE, Robert
10.	The North Side of the Middle Isle	KENDRICK, John, Booth's Farm
10.	The North Side of the Middle Isle	HAWARD, John, School Farm
10.	The North Side of the Middle Isle	FARMER, Joseph, Maney, Tenant of Thomas Addyes, Esq
11.	The North Side of the Middle Isle	KENDRICK, John, for the Farm of the late Mr Joseph Gibbons now Mrs Rilands
12.	The North Side of the Middle Isle	MOUSELEY, William, one sitting at the upper end + other former occupants
13.	The North Side of the Middle Isle	MOUSELEY, William, Sen <sup>r</sup> , one sitting at the upper end + other former occupants
14.	The North Side of the Middle Isle	MILNER, Thomas, Maney, Tenant of Thomas Addyes, Esq and old proprietors as usual
15.	The North Side of the Middle Isle	WELCH, John
15.	The North Side of the Middle Isle	HAWKESFORD, John, as usual
16.	The North Side of the Middle Isle	WARDEN of the Corporation, The
17.	The North Side of the Middle Isle	SACHEVERELL, Charles, Esq
18.	The North Side of the Middle Isle	ALLPORT, Henry, Tenant of the Manor Farm
19.	The North Side of the Middle Isle	PARSONAGE, The
20.	The North Side of the Middle Isle	PARSONAGE, The
21.	The North Side of the Middle Isle	PARSONAGE, The
22.	The North Side of the Middle Isle	PARSONAGE, The
23.	The South Side of the Middle Isle	PARSONAGE, The



24.	The South Side of the Middle Isle	PARSONAGE, The
25.	The South Side of the Middle Isle	ADDERLY, Mrs, for the house heretofore inhabited by Jeremiah Thaker
26.	The South Side of the Middle Isle	SIMMS, Daniel
26.	The South Side of the Middle Isle	KENDRICK, John
26.	The South Side of the Middle Isle	JESSON, Mr Albert, and other tenants of an Estate of late Mr Cooks
27.	The South Side of the Middle Isle	SEDGWICK, Henry and old proprietors as usual
28.	The South Side of the Middle Isle	KENDRICK, John, for New Shipton Farm
29.	The South Side of the Middle Isle	ROCHFORD, William, for Brooks Farm
29.	The South Side of the Middle Isle	GENDERS, William, Tenant of John Cooper's Farm
30.	The South Side of the Middle Isle	COOPER, William, for his house in Wylde Green + former occupants
31.	The South Side of the Middle Isle	MOUSELEY, William [Senior] for the late Hides Farm and former occupants
32.	The South Side of the Middle Isle	WEBSTER, Joseph, for Penns Mill Farm belonging to Mr Joseph Scott
33.	The South Side of the Middle Isle	HARGREAVE, Thomas, for his house, Little Sutton, and other proprietors as usual
34.	The South Side of the Middle Isle	KENDRICK, John, for Booth's Farm
35.	The South Side of the Middle Isle	BUNN, Raphael, one sitting + The Workhouse
36.	The South Side of the Middle Isle	ADDYES, John, Esq for former Bagnall's Fm, old proprietors as usual
37.	The South Side of the Middle Isle	Old Proprietors as usual
38.	The South Side of the Middle Isle	CARVER, Mary, for the Red Lyon
39.	The South Side of the Middle Isle	FORMER OCCUPANTS being old proprietors as usual
40.	The South Side of the Middle Isle	WOOD, Joseph, for an appendage to the Mill
41.	The South Side of the Middle Isle	as usual

### *The North Isle*

1.	The North Side of the North Isle	BUNN, James, and former occupants
2.	The North Side of the North Isle	ROCHFORD, John, for Isaac Mould's Estate
3.	The North Side of the North Isle	MILES, Dorothy, late Jeffs(?) and former occupants
4.	The North Side of the North Isle	HARGREAVE, Mary, and former occupants
5.	The North Side of the North Isle	OLD PROPRIETORS as usual
6.	The North Side of the North Isle	OLD PROPRIETORS as usual
7.	The North Side of the North Isle	OLD PROPRIETORS as usual
8.	The North Side of the North Isle	EAVES, Mrs
8.	The North Side of the North Isle	AUSTIN, Abraham, and other proprietors as usual
9.	The North Side of the North Isle	ADDYES, John, Esq for Duncumbs House + other proprietors as usual
10.	The North Side of the North Isle	HONEYBORNE, Widow, for Wm Rockford's House, one sitting
10.	The North Side of the North Isle	OUGHTON, Mr Joseph
11.	The North Side of the North Isle	SPOONER, John, for Mrs Bedford's House and other proprietors as usual
12.	The North Side of the North Isle	DUNKLEY, Mr Robert, in lieu of his right to No. 10(?) in this same isle
12.	The North Side of the North Isle	SADLER, Mrs
13.	The North Side of the North Isle	LOWE, Mr, for the Old School House
13.	The North Side of the North Isle	SAWYER, Mr John
14.	The North Side of the North Isle	RILAND, Mrs, and
14.	The North Side of the North Isle	FIELD, Mrs, as usual

15.	The North Side of the North Isle	KESTERTON, John, for Mr Orton's Farm
16.	The North Side of the North Isle	TWAMLEY, William + former occupants as usual
17.	The North Side of the North Isle	LUCAS, Thomas
17.	The North Side of the North Isle	WHATELEY, Richard
18.	The North Side of the North Isle	DAWSON, John, and other Tenants belonging to Emmanuel College
19.	The North Side of the North Isle	JESSON, William, Esq marked with his Crest
20.	The South Side of the North Isle	SACHEVERELL, Charles, Esq, his Chancel
21.	The South Side of the North Isle	SACHEVERILL, Charles, Esq, being in his Chancel
22.	The South Side of the North Isle	ADDYES, John, Esq, his Chancel
23.	The South Side of the North Isle	ADDYES, John, Esq, his Chancel
24.	The South Side of the North Isle	ADDYES, John, Esq, being in his Chancel
25.	The South Side of the North Isle	SMITH, Joseph, for the Tan House
26.	The South Side of the North Isle	ADDYES, John, Esq, for Moor Hall
27.	The South Side of the North Isle	AUSTIN, Abraham
28.	The South Side of the North Isle	HOMER, Edward, Mr
29.	The South Side of the North Isle	HOMER, Edward, Mr, Two Sitings + former occupiers
30.	The South Side of the North Isle	BREEDEN, Samuel
31.	The South Side of the North Isle	ALLPORT, Henry, for the Three Tunns and old proprietors as usual
32.	The South Side of the North Isle	ANDERTON, John, for a School House.
32.	The South Side of the North Isle	BROOKESs, John of Warmley
32.	The South Side of the North Isle	KENDRICK, John for Mrs Riland's Farm late Mr Gibbons
33.	The South Side of the North Isle	(??????), John
33.	The South Side of the North Isle	BAR???, William, Warmley, Tenant of Thos West, late Smallwood and old proprietors, as usual
34.	The South Side of the North Isle	LAMBLEY, William, for the Fox and Dogs + former occupants
35.	The South Side of the North Isle	HARROLD, John, for Phillip Mullineus Farm late (?????)
36.	The South Side of the North Isle	HUTTON, James, for School Farm
36.	The South Side of the North Isle	WORTHINGTON, William
37.	The South Side of the North Isle	TOMLINSON, Joshua, and new gained sitting to
37.	The South Side of the North Isle	HEATH, John, Mr Kendrick's tenant
38.	The South Side of the North Isle	HOLMES, Widow, for house at Wild Green, + former occupants
39.	The South Side of the North Isle	TOMPSON, John, a tenant of Mr Addyes

### *The North Gallery*

1.	The North Gallery	CRUMP, John, and his tenants
2.	The North Gallery	GRANGE, John, 3 sittings for his house on Mill St
2.	The North Gallery	REYNOLDS, Richard (2)
3.	The North Gallery	WHATLEY, Richard
4.	The North Gallery	WHATLEY, Richard, for Mrs Wheatstaffs Farm
4.	The North Gallery	HOLMES, William
4.	The North Gallery	GEAST, Richard, Esq
5.	The North Gallery	GRIFFIS, John
5.	The North Gallery	BONELL, Thos, Senior
6.	The North Gallery	GRANGE, John
6.	The North Gallery	WHITE, William
7.	The North Gallery	MARSH, Joseph
8.	The North Gallery	OULTON, Abraham 2
8.	The North Gallery	SWIFT, John 2
8.	The North Gallery	AUDLEY, Mrs

- 9. The North Gallery
- 9. The North Gallery
- 10. The North Gallery

LOWE'S SERVANTS, Mr, in lieu of No. 12 in the isle  
PERRY, Mr, for the Bulls Head  
LEE, John, for a house belonging to the School

### *The School Gallery*

- 11. The School Gallery
- 12. The School Gallery

LOWE, Mr, being part of the School Gallery  
LOWE, Mr, being part of the School Gallery